

### Small - HMX-10

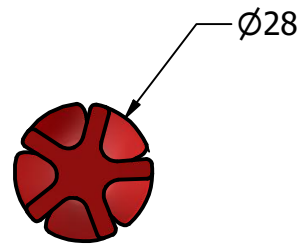

Weight: ~40g  
Shaft: Stainless Steel  
Ideal for mixing up to 2kg

### Medium - HMX-20

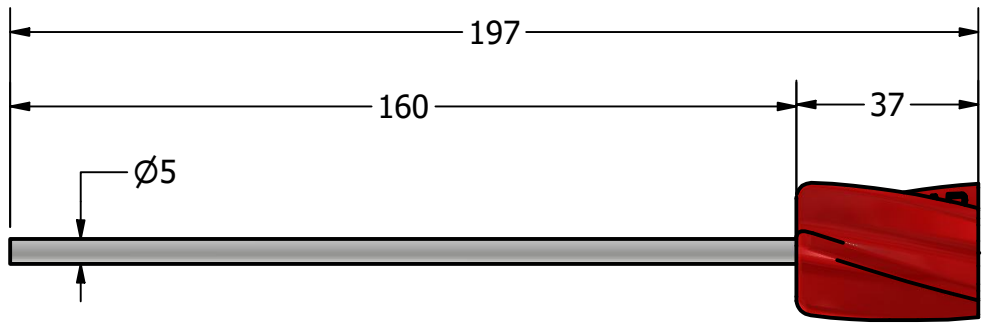
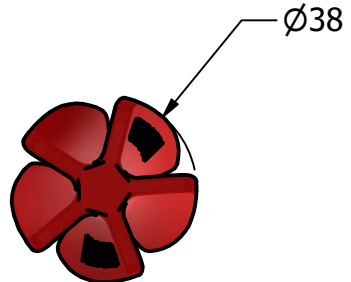
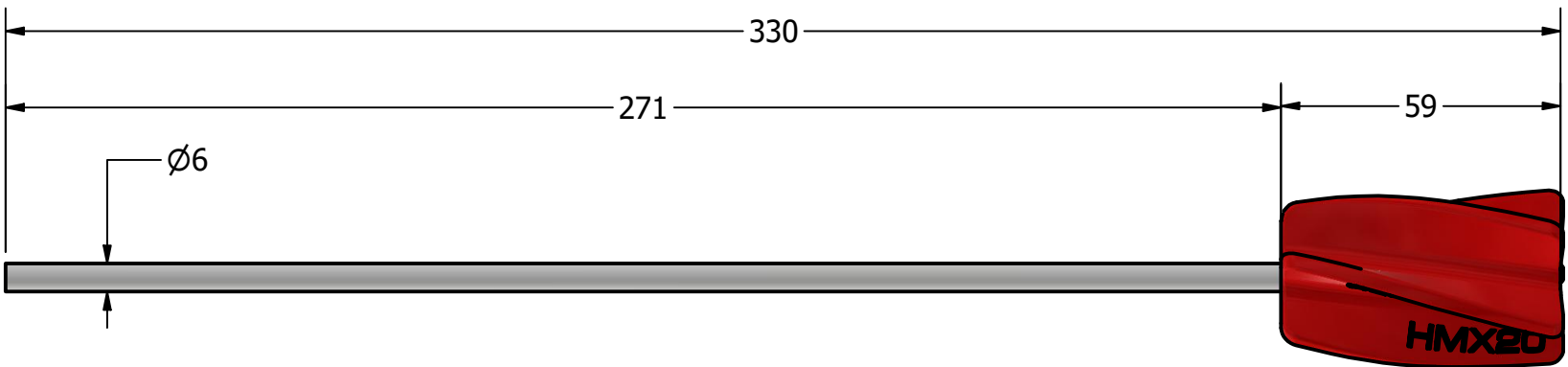

Weight: ~90g  
Shaft: Stainless Steel  
Ideal for mixing 2 - 5kg

### Large - HMX-30

Weight: ~360g  
Shaft: Zinc Plated Steel  
Ideal for mixing 5 - 40kg

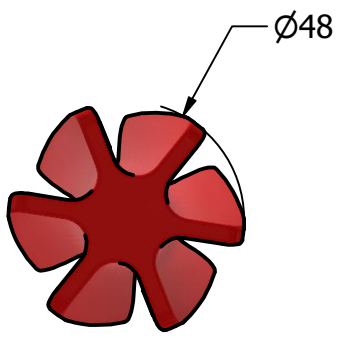
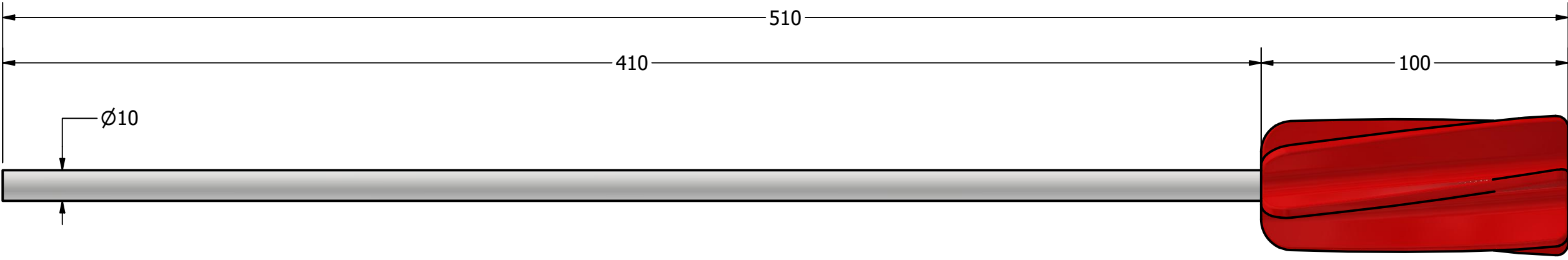

Length dimensions +/- 5mm